

SCALE: 1" = 40'



Know what's below.
Call before you dig.

LEGEND

-

SESC NOTES:

1. ALL SILT FENCE SHALL BE MAINTAINED THROUGHOUT DURATION OF THE PROJECT. IF AT ANY TIME THE DEPTH OF SILT AND SEDIMENT COMES TO THE SURFACE OF THE PROJECT, ALL SILT FENCE, ALL SILT AND SEDIMENT SHALL BE REMOVED TO ORIGINAL GRADE.
2. ALL TEMPORARY GRAVEL FILTERS SHOULD BE MAINTAINED AS TO NOT BE AFFECTED BY FIELD CONDITIONS. THE REMOVAL OF TRAPPED SEDIMENT AND THE CLEANOUT OR REPLACEMENT OF CLOGGED STORMS MAY BE NECESSARY AFTER EACH STORM EVENT DURING THE PROJECT.
3. ONLY UPON STABILIZATION OF ALL DISTURBED AREAS MAY THE SILT FENCE, AND TEMPORARY GRAVEL FILTERS BE REMOVED. ALL STORM SEWERS MUST BE CLEANED OF ALL SEDIMENT.
4. SEE SITE DETAILS SHEET FOR CONSTRUCTION SEQUENCE.
5. INTERNAL & EXTERNAL STREETS TO BE CLEANED OF ANY TRACKED MUD IMMEDIATELY FOLLOWING EACH MUD-TRACKING OCCURRENCE.
6. ESTIMATED COST TO STABILIZE SITE SHOULD CONSTRUCTION BE:
6.5ac X \$10,500/c ac = \$68,250
7. ESTIMATED SLO MOVEMENTS ON SITE:
10,200 C.Y CUT; 2680 C.Y. FILL
8. NPDES/NOI PERMIT REQUIRED FOR PROJECT. INSPECTIONS TO BE PERFORMED BY CERTIFIED MDEQ STORM WATER OPERATOR. REPORTS TO REMAIN ON FILE. TO BE CONDUCTED ONCE A WEEK AND IMMEDIATELY FOLLOWING EACH PRECIPITATION EVENT.
9. PERMANENT SOIL EROSION CONTROLS ARE REQUIRED TO BE INSTALLED WITHIN FIVE (5) DAYS AFTER FINISH GRADING.
10. AFTER SITE GRADING ALL DISTURBED AREAS NOT IMMEDIATELY UNDER CONSTRUCTION ARE TO BE STABILIZED.
11. THE DETENTION FACILITIES SHALL BE CONSTRUCTED IN CONJUNCTION WITH BUILDING FOUNDATION SYSTEMS AS THESE SYSTEMS ARE INTERVAL WITH EACH OTHER. SEE CONSTRUCTION SEQUENCE FOR FOUNDATION CONSTRUCTION.

SOIL EROSION COST ESTIMATE

Site Preparation and SESC					\$19,817.50
Temporary					
Stone Mul Tracking Mat	3	ea	\$2,650.00		\$7,950.00
Silt Fence	1600	ft	\$3.10		\$4,960.00
Tree Protection Fence	350	ft	\$2.25		\$787.50
Root Filter	34	ea	\$180.00		\$6,120.00

SOIL EROSION CONTROL MEASURES

t = temporary p = permanent



Logistics Plan Phase 1 Sequence 1



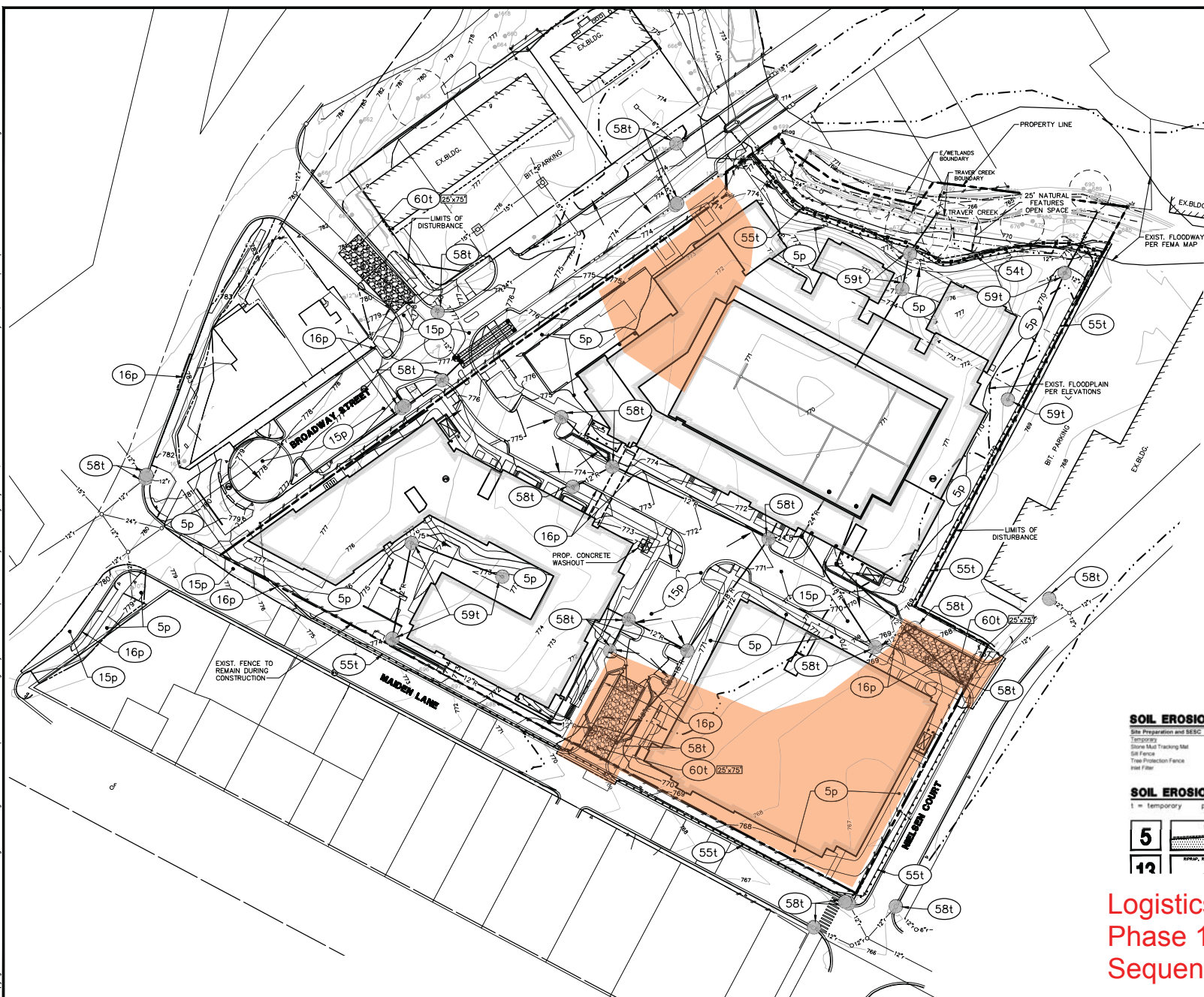

SCALE: 1" = 40'



Know what's below.
Call before you dig.

LEGEND

-

SESC NOTES:

1. ALL SILT FENCE SHALL BE MAINTAINED THROUGHOUT THE DURATION OF THE PROJECT. IF AT ANY TIME THE DEPTH OF SILT AND SEDIMENT COMES TO WITHIN THE 12" OF THE SURFACE OF ANY SILT FENCE, ALL SILT AND SEDIMENT SHALL BE REMOVED TO ORIGINAL GRADE.
2. ALL TEMPORARY GRADE FILTERS SHOULD BE ADJUSTED AS TO LOCATION PER ACTUAL FIELD CONDITIONS. THE REMOVAL OF TRAPPED SEDIMENT AND CLEANOUT OF THE DEPTH OF CLOGGED STONE MAY BE NECESSARY AFTER EACH STORM EVENT DURING THE PROJECT.
3. ONLY UPON STABILIZATION OF ALL DISTURBED AREAS AND THE SILT FENCES AND TEMPORARY GRADE FILTERS BE REMOVED, ALSO, ALL STORM SEWERS MUST BE CLEANED OF ALL SEDIMENT.
4. SEE SITE DETAILS SHEET FOR CONSTRUCTION SEQUENCE
5. INTERNAL & EXTERNAL STREETS TO BE CLEANED OF ANY TRACKED MUD IMMEDIATELY FOLLOWING EACH MUD-TRACKING OCCURRENCE.
6. ESTIMATED COST TO STABILIZE SITE SHOULD CONSTRUCTION BE:
6.5ac X \$105,000/c ac = \$68,250
7. ESTIMATED SOIL MOVEMENTS ON SITE:
10,200 C.Y. CUT; 2680 C.Y. FILL.
8. NPDES/NOI PERMIT REQUIRED FOR PROJECT.
9. INSPECTIONS TO BE PERFORMED BY CERTIFIED MUD TRAP WATER OPERATOR. REPORTS TO REMAIN ON FILE TO BE COMPLETED IMMEDIATELY FOLLOWING EACH PRECIPITATION EVENT.
10. PERMANENT SOIL EROSION CONTROLS ARE REQUIRED TO BE INSTALLED WITHIN FIVE (5) DAYS AFTER FINISH GRADING.
11. AFTER SITE GRADING ALL DISTURBED AREAS NOT IMMEDIATELY UNDER CONSTRUCTION ARE TO BE STABILIZED.
12. THE DETENTION FACILITIES SHALL BE CONSTRUCTED IN ACCORDANCE WITH THE DETENTION TREATMENT SYSTEMS AS THESE SYSTEMS ARE INTEGRAL WITH EACH OTHERS. SEE CONSTRUCTION SEQUENCE FOR FURTHER INFORMATION.

SOIL EROSION COST ESTIMATE

Site Preparation and SESC					\$19,817.80
Temporary					
Stone Mulch Tracking Mat	3	ea	\$2,950.00	\$7,950.00	
Silt Fence	1600	ft	\$3.10	\$4,960.00	
Tree Protection Fence	350	ft	\$2.25	\$787.50	
Root Filter	34	Ea	\$180.00	\$6,120.00	

SOIL EROSION CONTROL MEASURES

t = temporary p = permanent



Logistics Plan Phase 1 Sequence 2



